

(Stewardson
- Potter)

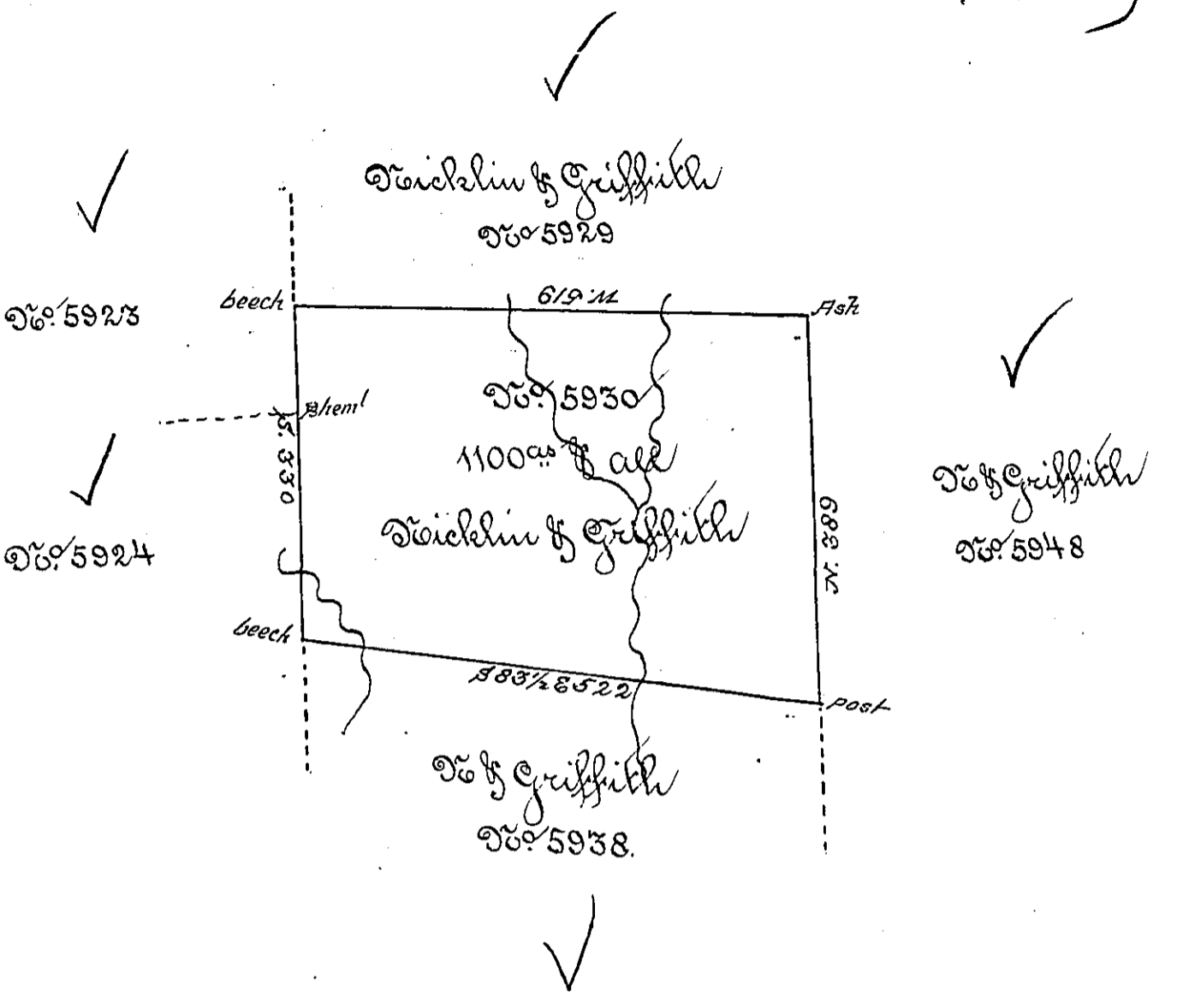

Surveyed 9^{mo} the 6th 1805 the above tract of land for Philip Weicklin & Robert E. Griffith assignees of Joseph Boone by virtue of their warrant 5930 dated 19th March 1805 situate on the waters of Tottle Creek in the late purchase Potter County containing one thousand one hundred acres and allowance of six per cent

Saul Cochran Esq }
Surveyor Genl }

William Ellis D.S

IN TESTIMONY that the above is a copy of the original remaining on file in the Department of Internal Affairs of Pennsylvania, made conformably to an Act of Assembly approved the 16th day of February, 1833, I have hereunto set my Hand and caused the Seal of said Department to be affixed at Harrisburg, this third day of November, 1896.

James W. Pitta
Secretary of Internal Affairs.